

U - measure up ...

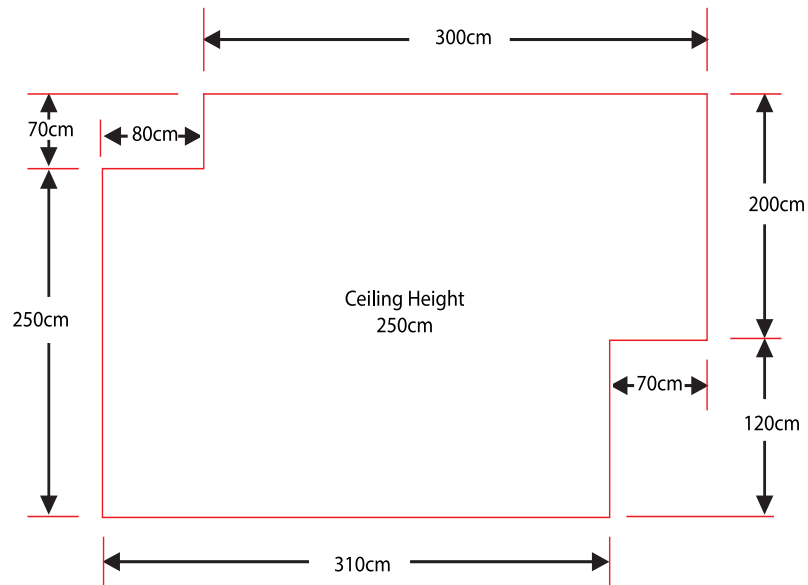

Step 1

Sketch a diagram of your kitchen with all wall measurements. You will also need to measure your ceiling height.



KEY	Plumbing
Window	Stove
Arch	Door



Step 2

Now you need to add all of the doors, windows, archways, plumbing points, position of your stove and any other appliance that may form part of your kitchen. Start at the left of the room and work your way clockwise, around the room, taking all measurements.

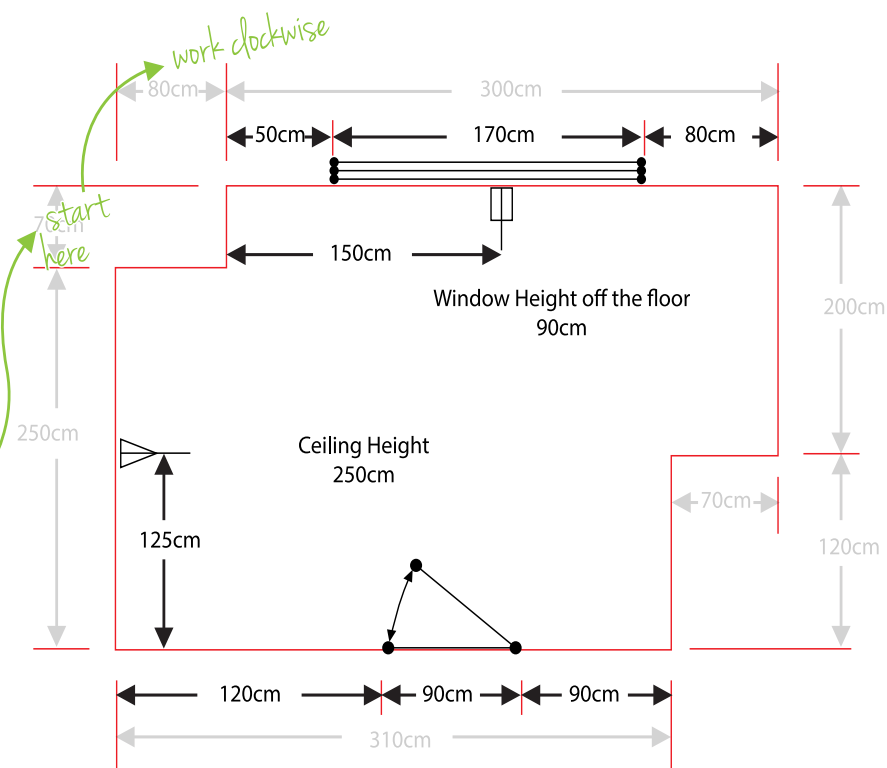

U-BUY • U-FIT • U-SAVE
U-PLAN
 DIY KITCHENS - BUILT IN CUPBOARDS
 U-PLAN is a product only from Lammel Manufacturing



TIP...

When adding windows, doors or any openings, start at the left of the room and work clockwise around it. Measure from the corner of the room to the window opening (A). Then measure the inside of the window (B), then from the window to the next corner (C). You also need the height of the window off the floor (D)

